

5600 CARLISLE PIKE MECHANICSBURG, PA

DEMOGRAPHICS

	1 Mile	3 Miles	5 Miles
Population	4,934	61,941	127,202
Average HHI	\$96,368	\$96,555	\$94,801
Daytime Pop	5,238	38,591	72,836



NOW AVAILABLE

Approximately
8,826 Square Feet

SITE HIGHLIGHTS

- Located on the West Shore of Harrisburg, the center is on the Carlisle Pike, Mechanicsburg's strongest retail corridor.
- Highest market demographics in Central PA
- At signalized interstation with more than 36,000 VPD
- Within a 5-Milre radius there are 127,202 people, with an average household income of \$94,801

Centrally Located on Route 11/Carlisle Pike Accessible from:

I-83 • I-76/PA Turnpike • I-81 • PA 581/Capital Beltway • Route 15

JOIN MAJOR TENANTS:

Marshalls

HomeGoods

**HOBBY
LOBBY**

Burlington



POMEGRANATE RE
33 Rock Hill Road, Suite 350
Bala Cynwyd, PA 19004

Karen Martin
Phone: (717) 848-6136
E-Mail: karen@pomre.com

 **Pomegranate
REAL ESTATE**
POMRE.COM

5600 CARLISLE PIKE MECHANICSBURG, PA

TENANT SPACE

- | | | |
|--------------|------------------------------|----------------|
| 1. HomeGoods | 3. Burlington | 5. Hobby Lobby |
| 2. Marshalls | 4. AVAILABLE—8,826 SF | 6. Metro Diner |



5600 CARLISLE PIKE MECHANICSBURG, PA

Available
Approximately
8,826 Square Feet

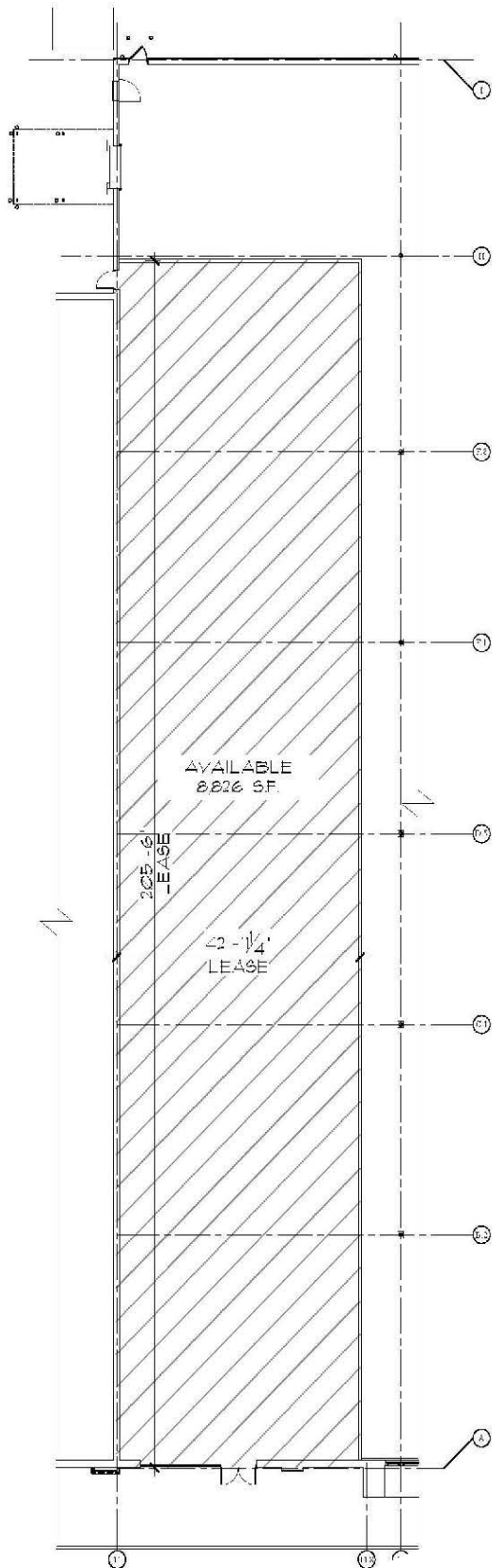

Pomegranate
REAL ESTATE
— POMRE.COM —

POMEGRANATE RE
33 Rock Hill Road, Suite 350
Bala Cynwyd, PA 19004

Karen Martin
Phone: (717) 848-6136
E-Mail: karen@pomre.com



Pomegranate
REAL ESTATE
— POMRE.COM —